

## Instruction of Maintenance

(ADT916 Pump)

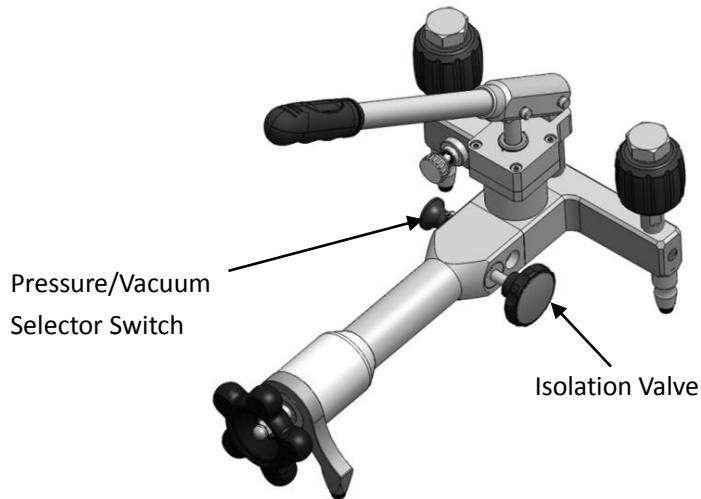

### Repairing isolation valve

1. Remove the nut cover of the isolation valve

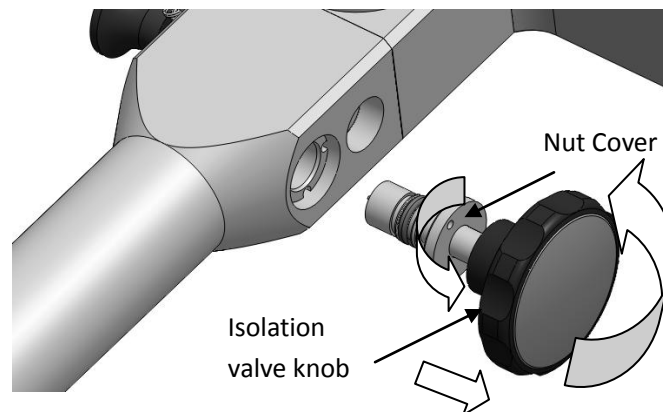

Turn the isolation valve counterclockwise to about half way out.

Turn the nut cover counterclockwise and completely remove it.

Turn the isolation valve counterclockwise completely out, and pull out the isolation valve.

2. Replace the O-ring of the isolation valve

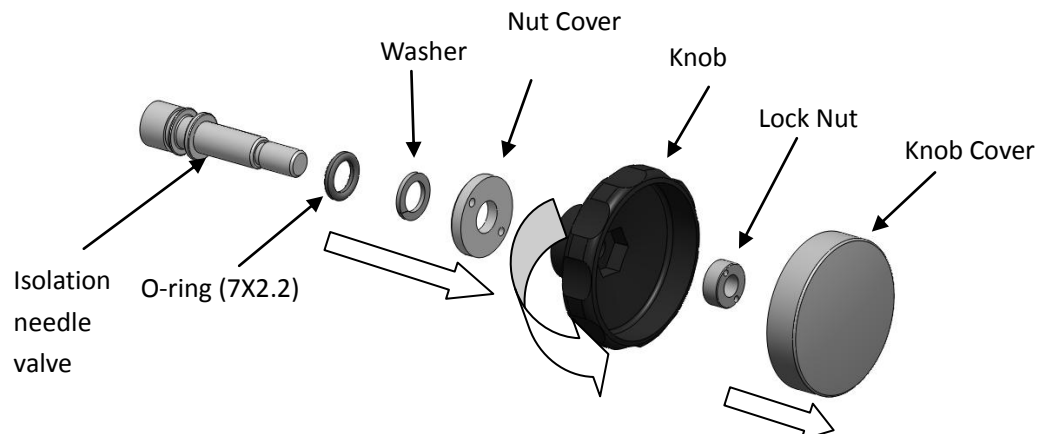

- A. Remove the knob cover
- B. Turn the lock nut counterclockwise and completely remove from the isolation needle valve
- C. Turn the knob counterclockwise and completely remove it from the isolation needle valve
- D. Remove the nut cover, washer, O-ring (7X2.2) from the isolation needle valve one by one.
- E. Replace the O-ring (7X2.2), and assemble all parts back in reverse order

## Repairing Pressure/Vacuum Selector switch

1. Remove the knob of the isolation valve

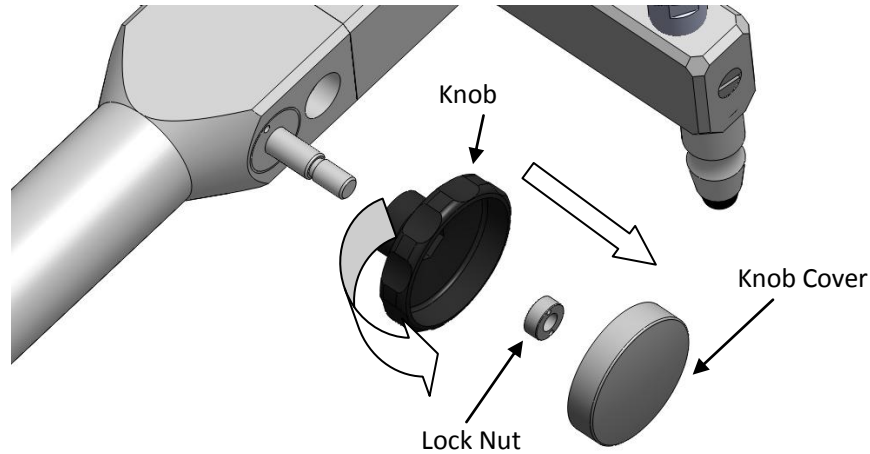

- A. Turn the isolation valve counterclockwise to about half way out.
- B. Remove the knob cover
- C. Turn the nut cover counterclockwise and completely remove it.
- D. Turn the isolation valve knob counterclockwise and completely remove it.

2. Remove the knob of Pressure/Vacuum Selector Switch

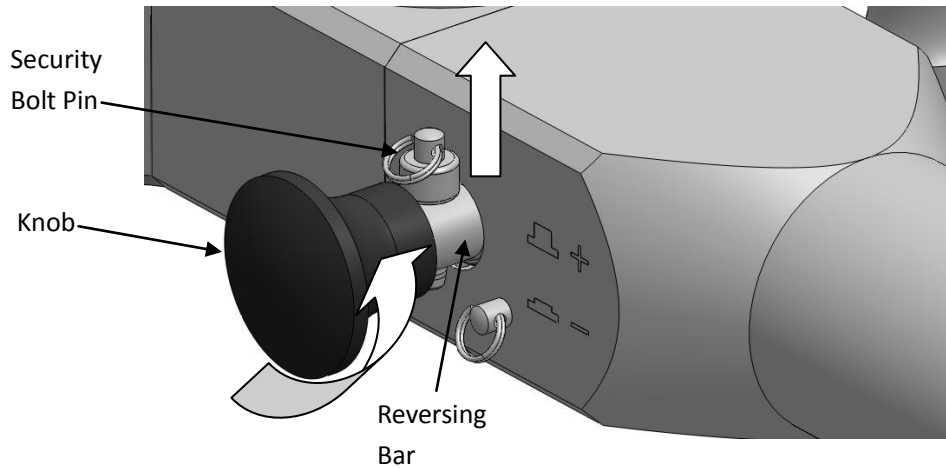

- A. Remove the security bolt pin
- B. Turn the knob counterclockwise and completely remove it

3. Replace the O-ring of Pressure/Vacuum Selector switch

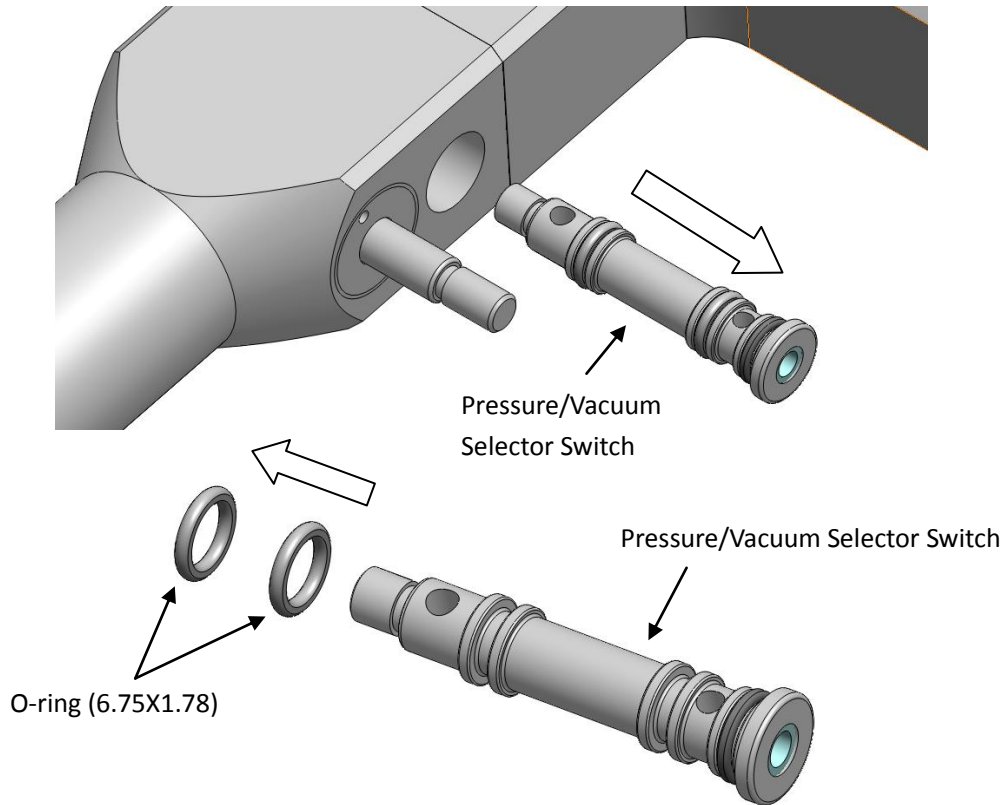

- A. Pull the Pressure/Vacuum Selector switch out of the pump
- B. Remove the O-rings (6.75X1.78) one by one.
- C. Replace the O-ring (6.75X1.78), and assemble all parts back in reverse order

## Replacing Vacuum Check Valve

1. Disassemble pre-pressurization piston unit

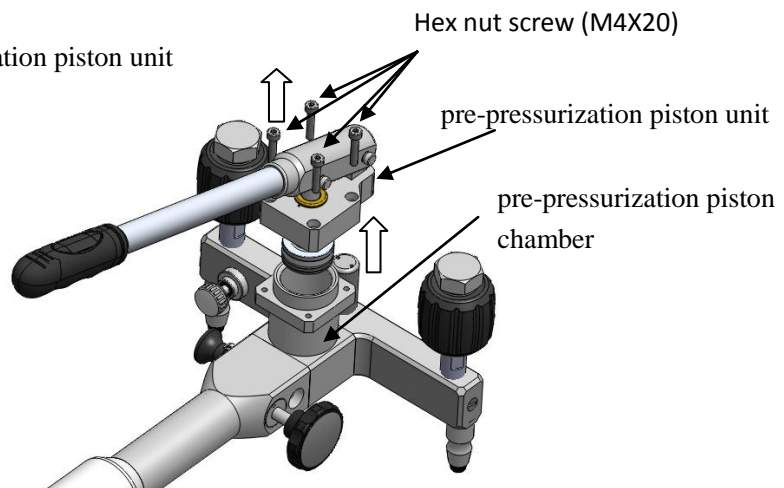

- A. Turn the hex nut screw (M4X20) counterclockwise and completely remove it
  - B. Pull pre-pressurization piston unit out of piston chamber
2. Replace vacuum check valve

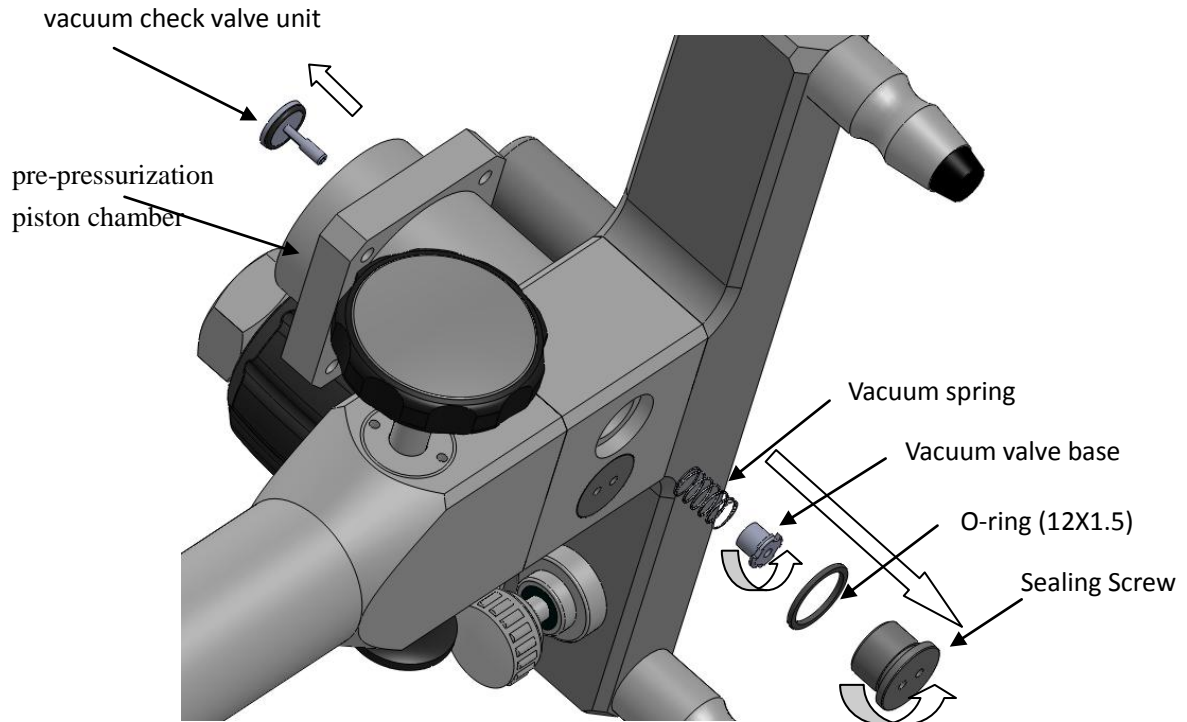

- A. Turn the sealing screw counterclockwise and completely remove it
- C. Hold vacuum check valve unit, turn the vacuum check valve counterclockwise, and completely separate the check valve and valve core
- B. Pull the vacuum check valve unit from piston chamber, and replace the check valve.
- C. Assemble all parts back in reverse order

## Replacing Pressure Check Valve

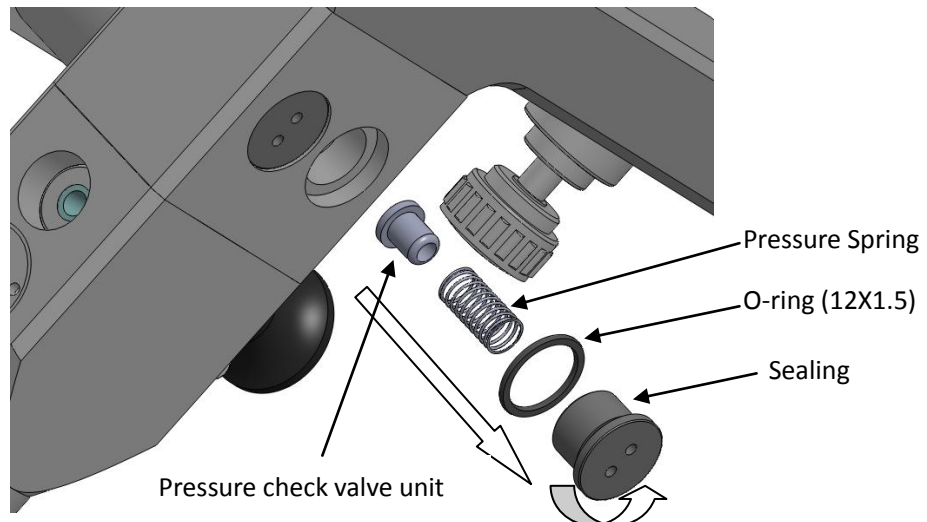

- A. Turn the sealing screw counterclockwise and completely remove it
- D. Hold vacuum check valve unit, turn the vacuum check valve counterclockwise, and completely separate the check valve and valve core
- B. Remove the pressure check valve unit from piston chamber, and replace the check valve.
- C. Assemble all parts back in reverse order

## Replacing O-ring of Pre-pressurization Piston

### 1. Disassemble pre-pressurization piston unit

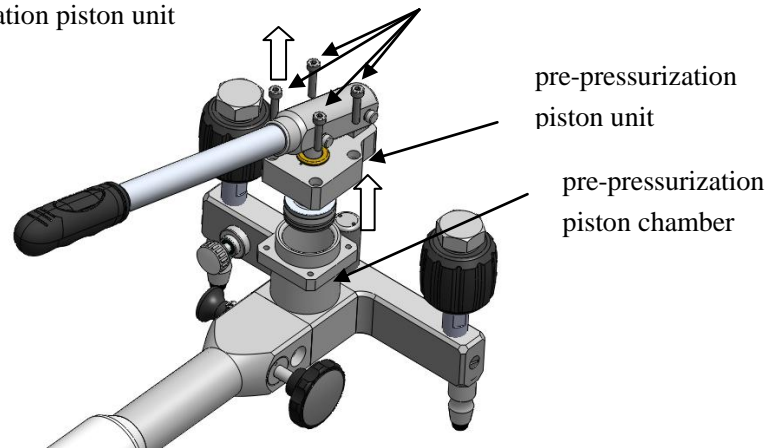

A. Turn the hex nut screw (M4X20) counterclockwise and completely remove it

B. Pull pre-pressurization piston unit out of piston chamber

### 2. Replace the O-ring of pre-pressurization piston unit

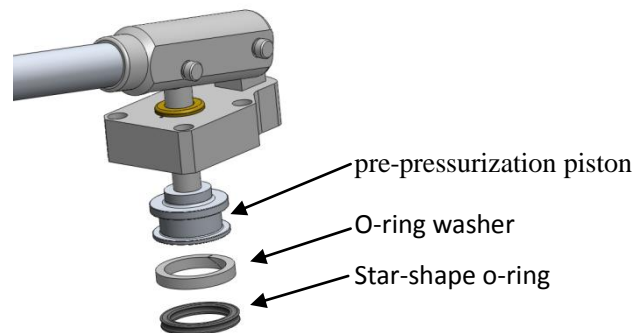

A. Remove the star-shape o-ring (21.82X3.53) from pre-pressurization piston. Replace the o-ring, and assemble all parts back in reverse order.